

## Quick Connecting Tube Fittings

### WPHT-G(2) SERIES



#### Product features

- One-Touch tube fittings are used in pneumatics piping.
- The tube fittings come in wide variety of models to meet all your needs in pneumatics piping.
- Even after installation, in direction of the tube can be changed freely.
- Nickel-plated metal body ensures Anti-Corrosion and Anti-Contamination.
- All R and NPT threads are Pre-Costed sealant.
- All cylindrical threads are standard with O-Ring seals.

#### Speciality

Fluid	Air, Vacuum
Operating Pressure	0-1.0MPa (150 psi)
Negative Pressure	-100KPa(-29.5 in-Hg)
Max Pressure	1.5MPa
Operating Temperature	0-60°C(32-140°F)
Applicable Tube	Polyurethane and Nylon

#### Dimension

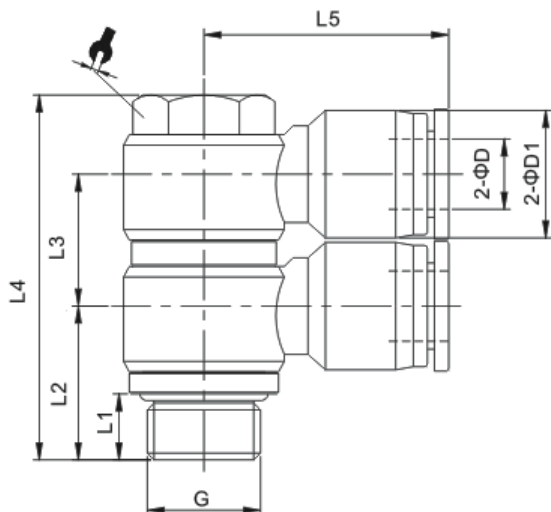

MODEL	φD	G	L1	L2	L3	L4	L5	φD1	
WPHT04-G01(2)	4	G1/8	5.5	14	15	38	23.5	11.5	12
WPHT04-G02(2)	4	G1/4	7.5	17.3	15	41.5	25.5	11.5	14
WPHT06-G01(2)	6	G1/8	5.5	14	15	38	23.5	13.5	12
WPHT06-G02(2)	6	G1/4	7.5	17.3	15	41.5	25.5	13.5	14
WPHT06-G03(2)	6	G3/8	7.5	19	15.7	49.5	29.5	13.5	19
WPHT08-G01(2)	8	G1/8	5.5	15	15	38	26.5	15	12
WPHT08-G02(2)	8	G1/4	14	18.3	15	41.5	29	15	14
WPHT08-G03(2)	8	G3/8	17	19	15.7	49.5	30	15	19
WPHT08-G04(2)	8	G1/2	10	24.5	21.5	57	32.5	15	24
WPHT10-G01(2)	10	G1/8	5.5	16.8	19	42.5	30.5	19	12
WPHT10-G02(2)	10	G1/4	7.5	20	21.5	44.8	32.5	19	14
WPHT10-G03(2)	10	G3/8	7.5	21	21.5	53	33	19	19
WPHT10-G04(2)	10	G1/2	10	25	21.5	60	36	19	24
WPHT12-G02(2)	12	G1/4	7.5	21.5	21.5	44.8	33.5	21.5	14
WPHT12-G03(2)	12	G3/8	7.5	22	21.5	53	35.5	21.5	19
WPHT12-G04(2)	12	G1/2	10	26	21.5	60.5	36.5	21.5	24